

CONSTRUCTION SEQUENCE (INTERMEDIATE B)

1. MAINTAIN ALL INSTALLED BMP'S. REMOVE SEDIMENT AS REQUIRED.
2. GRASS ALL FINAL SLOPES WITH PERMANENT GRASSING (Ds3) AND MATTING (Ss).
3. INSTALL DOUBLE ROW OF SILT FENCE (Sd1-S) IN NORTHEAST CORNER.
4. CONTINUE FILLING TO THE NORTH END OF THE PAD.
5. INSTALL STORM SEWER AND INLET PROTECTION (Sd2-F).
6. CONSTRUCT CONSTRUCTION ROAD (Cr) ALONG PERIMETER OF PAD.
7. CONSTRUCT BUILDING PAD AND PLACE STONE BASE ON ALL AREAS AT FINISHED GRADE.

NOTE: AT THE END OF EACH DAY, CONSTRUCT A SAFETY FENCE AROUND ALL SEDIMENT BASINS OR TRAPS, DITCHES, TRENCHES, HOLES, ETC. WITH 2:1 OR STEEPER SLOPES AND A DEPTH GREATER THAN 24".

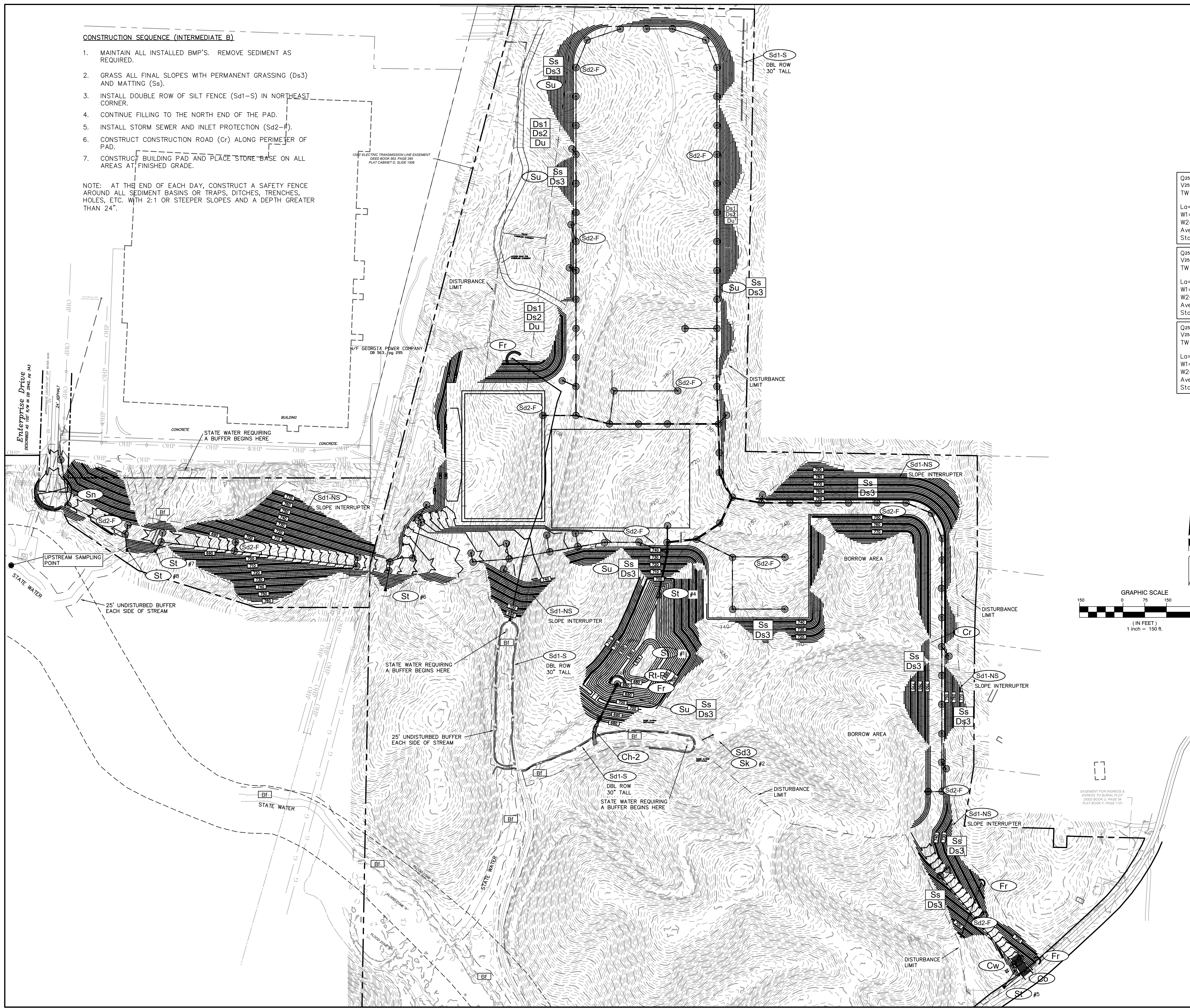

Q25=8.7 cfs V25=7.5 fps TW < Pipe 1/2 ø	(St) #6
L0=10' W1=6' W2=16' Average stone diameter (d50)=8" Stone depth (D)=16"	
Q25=12.9 cfs V25=10.4 fps TW < Pipe 1/2 ø	(St) #7
L0=15' W1=6' W2=21' Average stone diameter (d50)=8" Stone depth (D)=16"	
Q25=9.8 cfs V25=8.5 fps TW < Pipe 1/2 ø	(St) #8
L0=12' W1=6' W2=18' Average stone diameter (d50)=8" Stone depth (D)=16"	

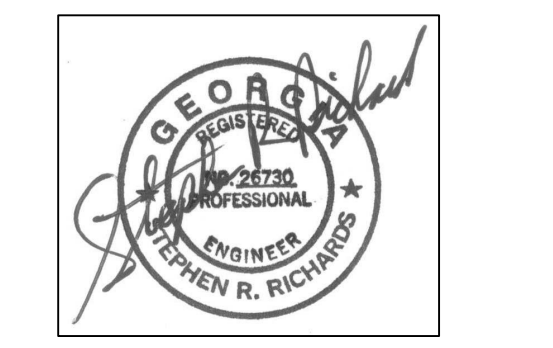
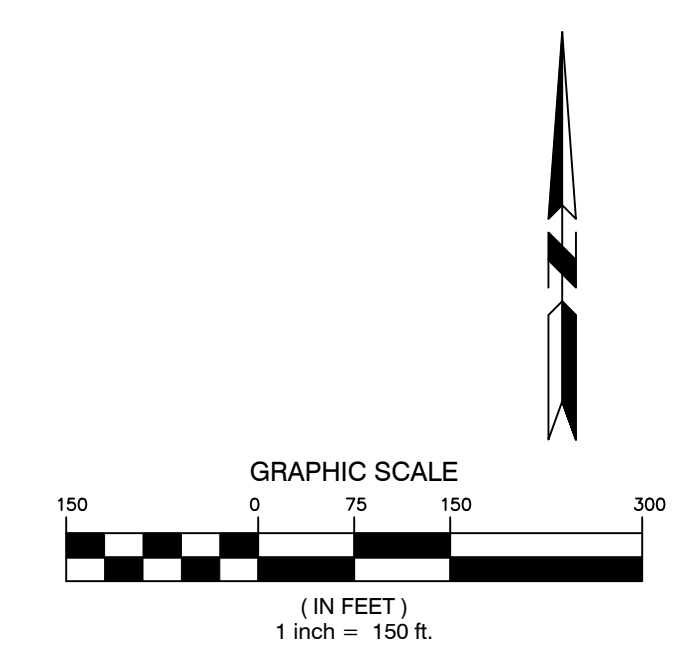

GA PROFESSIONAL ENGINEER NO. 26730
LEVEL II CERTIFIED DESIGN PROFESSIONAL NO. 8688

PROJECT
CORE DALTON 4
ENTERPRISE DRIVE
DALTON, GA
CLIENT
CORE SCIENTIFIC, INC.
838 WALKER ROAD, SUITE 21-2105
DOVER, DE 19904

© RICHARDS & ASSOC. ENGINEERING, INC.
UNLESS THIS DRAWING IS STAMPED, SIGNED AND DATED BY THE DESIGN PROFESSIONAL, NO PART OF THIS DRAWING SHALL BE USED FOR CONSTRUCTION. RICHARDS & ASSOCIATES ENGINEERING, INC. IS NOT LIABLE FOR ANY MISTAKE OR OMISSION IN THIS DRAWING.
THIS DRAWING AND DESIGN ARE THE PROPERTY OF RICHARDS & ASSOCIATES ENGINEERING, INC. AND ARE NOT TO BE REPRODUCED OR TRANSMITTED IN ANY FORM OR BY ANY MEANS, ELECTRONIC OR MECHANICAL, INCLUDING PHOTOCOPYING, RECORDING, OR BY ANY INFORMATION STORAGE AND RETRIEVAL SYSTEM, WITHOUT THE WRITTEN CONSENT OF RICHARDS & ASSOCIATES ENGINEERING, INC. ALL COMMON LAW RIGHTS OF COPYRIGHT AND OTHERWISE ARE HEREBY SPECIALLY RESERVED.
THIS DRAWING SHEET MAY BE PART OF A COMPLETE SET OF DESIGN DRAWINGS AND SHOULD NOT BE SEPARATED FROM THE SET. INFORMATION PERTAINING TO THIS SHEET MAY BE FOUND ON OTHER SHEETS IN THE SET.
IF ANY CONFLICTS, DISCREPANCIES OR OTHER UNSATISFACTORY CONDITIONS ARE DISCOVERED EITHER IN THE CONSTRUCTION DOCUMENTS OR THE FIELD, THE CONTRACTOR MUST NOTIFY THE ENGINEER IMMEDIATELY AND SHALL NOT COMMENCE OPERATION UNTIL THE CONFLICTS, DISCREPANCIES, OR OTHER UNSATISFACTORY CONDITIONS ARE RESOLVED.
THIS PLAN CANNOT BE USED FOR CONSTRUCTION UNLESS THEY HAVE BEEN APPROVED, SIGNED AND SEALED BY THE APPROPRIATE AUTHORITIES AND ALL NECESSARY PERMITS HAVE BEEN OBTAINED BY THE OWNER. THE OWNER IS RESPONSIBLE FOR PROVIDING ALL NECESSARY PERMITS.

Revisions	Date
PCR 03	8/1/25

Drawing Title	
INTERMEDIATE B SOIL EROSION SEDIMENTATION AND POLLUTION CONTROL PLAN	
DATE	5/16/25
PROJECT NO.	24-036
DRAWING NO.	C3.1

RELEASE SCHEDULE	
INITIAL SUBMITTAL	3/24/25
COUNTY COMMENTS	4/4/25
EARLY RELEASE	5/2/25
ISSUED FOR PERMIT	5/16/25